

LITE010

500W MID TOWER CHASSIS

**OUTER
CHARACTERISTICS**
Dimensions

**INNER
CHARACTERISTICS**

SPECIFICATIONS

**COMPACT IN THE OUTSIDE,
BROAD IN THE INSIDE**

LITE010 is the Nox solution to those who need a high performance equipment but without sacrificing nor space or an efficient execution.

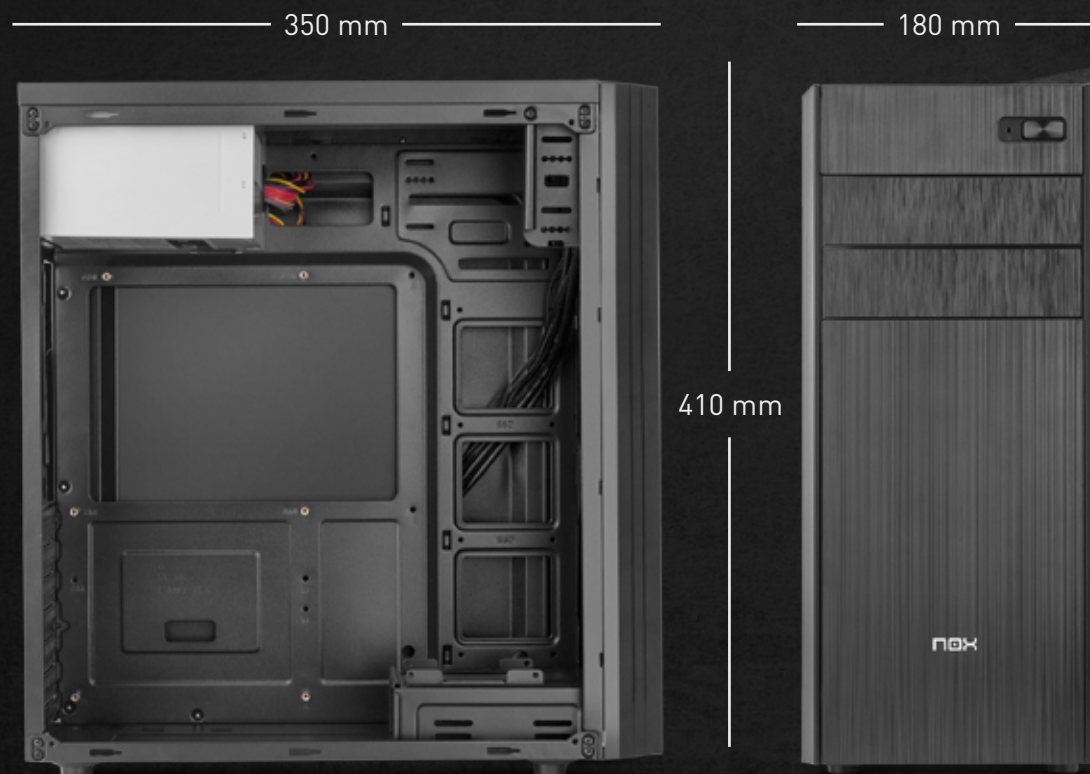

LITE010

500W MID TOWER CHASSIS

OUTER CHARACTERISTICS

Connections

INNER CHARACTERISTICS

SPECIFICATIONS

**COMPACT IN THE OUTSIDE,
BROAD IN THE INSIDE**

LITE010 is the Nox solution to those who need a high performance equipment but without sacrificing nor space or an efficient execution.

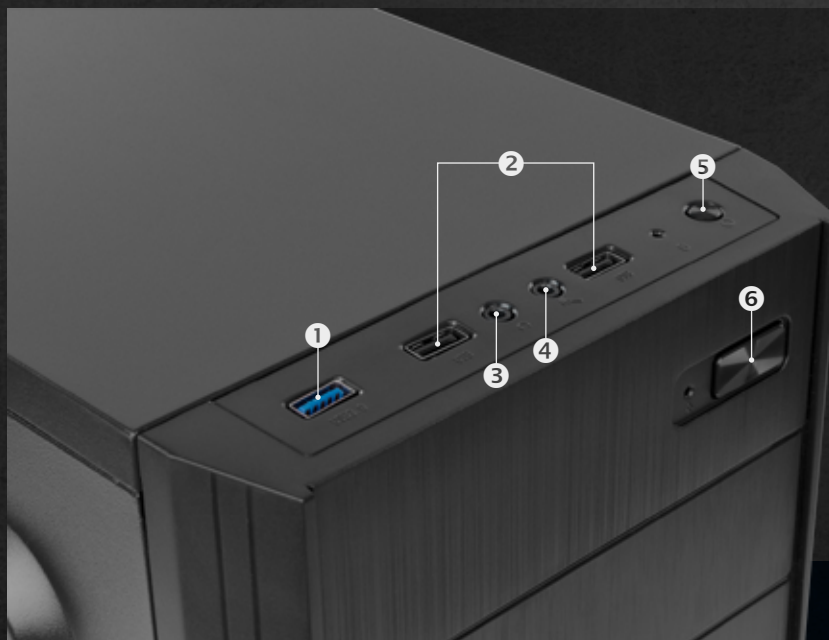

CONNECTIONS

01. USB 3.0

02. USB 2.0

03. Microphone Input (3.5mm Jack)

04. Audio Input (3.5mm Jack)

05. Reboot Button

06. On / Off Button

LITE010

500W MID TOWER CHASSIS

OUTER CHARACTERISTICS

INNER CHARACTERISTICS

Cooling System

SPECIFICATIONS

**COMPACT IN THE OUTSIDE,
BROAD IN THE INSIDE**

LITE010 is the Nox solution to those who need a high performance equipment but without sacrificing nor space or an efficient execution.

REAR
120 mm (1x)
OPTIONAL

FRONT
120 mm (2x)
OPTIONAL

SIDE
120 mm (1x)
OPTIONAL

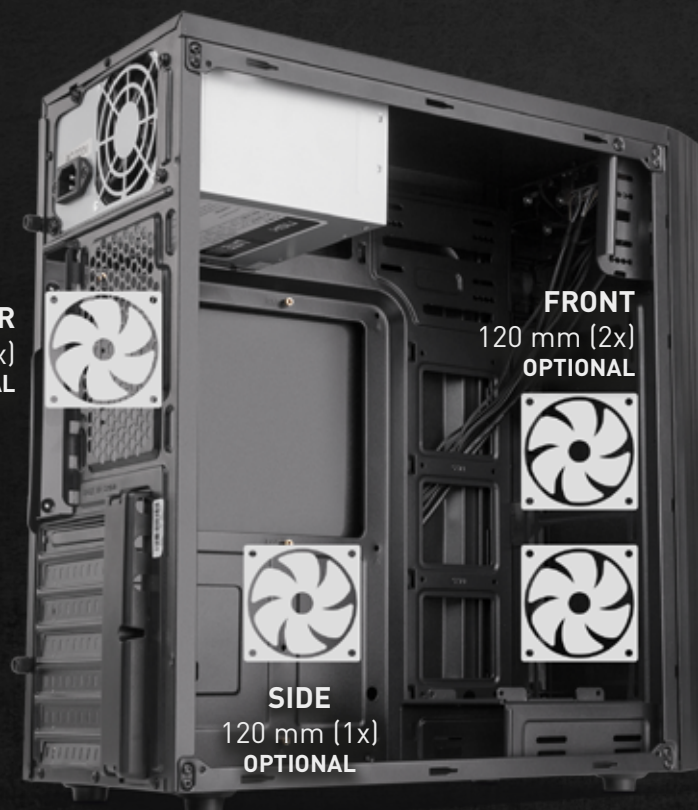

LITE010

500W MID TOWER CHASSIS

OUTER CHARACTERISTICS

INNER CHARACTERISTICS

Airflow

SPECIFICATIONS

**COMPACT IN THE OUTSIDE,
BROAD IN THE INSIDE**

LITE010 is the Nox solution to those who need a high performance equipment but without sacrificing nor space or an efficient execution.

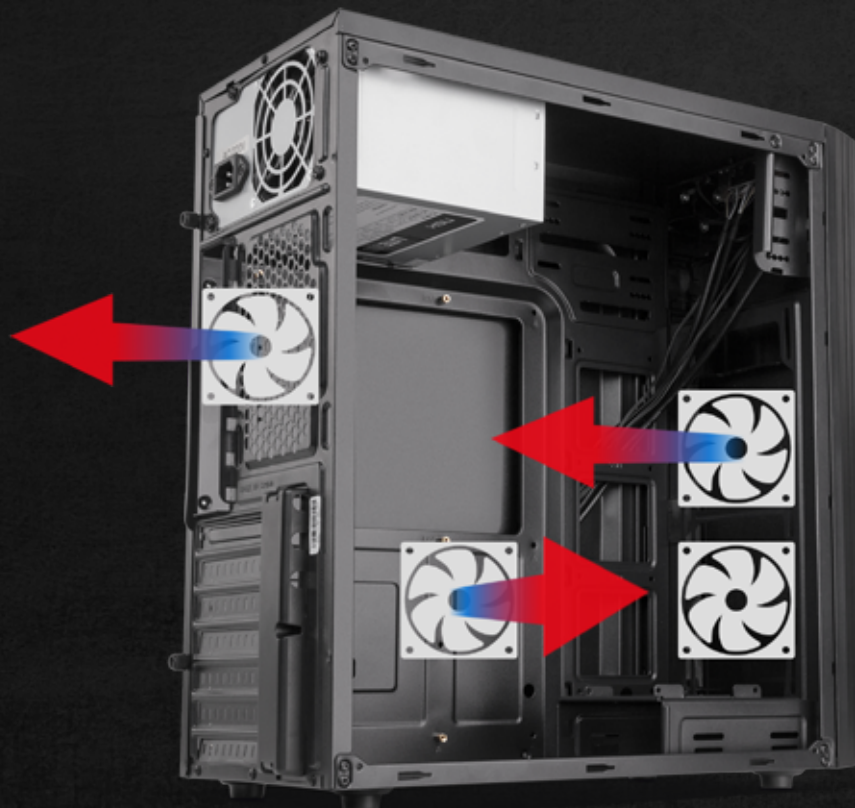

LITE010

500W MID TOWER CHASSIS

OUTER CHARACTERISTICS

INNER CHARACTERISTICS

Internal Space

SPECIFICATIONS

COMPACT IN THE OUTSIDE, BROAD IN THE INSIDE

LITE010 is the Nox solution to those who need a high performance equipment but without sacrificing nor space or an efficient execution.



LITE010

500W MID TOWER CHASSIS

OUTER CHARACTERISTICS

INNER CHARACTERISTICS

Storage SPECIFICATIONS

**COMPACT IN THE OUTSIDE,
BROAD IN THE INSIDE**

LITE010 is the Nox solution to those who need a high performance equipment but without sacrificing nor space or an efficient execution.



LITE010

500W MID TOWER CHASSIS

**COMPACT IN THE OUTSIDE,
BROAD IN THE INSIDE**

LITE010 is the Nox solution to those who need a high performance equipment but without sacrificing nor space or an efficient execution.

OUTER CHARACTERISTICS

INNER CHARACTERISTICS

CONNECTIONS 1x USB 3.0 • 2x USB 2.0 • HD Audio

RL OPTION 120 mm radiator

MAX. GRAPHIC CARD 345 mm

MAX. CPU COOLER 165 mm

CABLE MANAGEMENT 21 mm

DIMENSIONS 350(D) x 180(W) x 410(H)

WEIGHT (WITHOUT PSU) 2,60 Kg

WEIGHT (WITH PSU) 3,40 Kg

POWER SUPPLY

- 500W
- ATX
- CONNECTORS:
 - 3x SATA
 - 1x Molex 4pin
 - 1x ATX 20/24 pin
 - 1x CPU 4 pin
 - 1x FDD

PN: NXLITE010 • **EAN:** 8436532167829

EXTRAS

- Brushed finish front panel
- High speed USB 3.0
- Up to 4 fans capability
- Power supply included

CHASSIS TYPE SIZE Mid tower

MOTHERBOARD FORM FACTOR ATX • Micro ATX • ITX

EXTERNAL DRIVE BAYS 1x 5.25"

INTERNAL DRIVE BAYS 2x 3.5" / 3x 2.5"

COOLING SYSTEM

- Front: 2x 120 mm (optional)
- Side: 1x 120 mm (optional)
- Rear: 1x 120 mm (optional)

EXPANSION SLOTS 7

MATERIAL

- ABS plastic
- SPCC 0.5 mm steel chassis

COLOR Black

PN: NXLITE010 • **EAN:** 8436532167829

PN: NXLITE010 • **EAN:** 8436532167829