

LITE020

500W MID TOWER CHASSIS

**COMPACT IN THE OUTSIDE,
BROAD IN THE INSIDE**

LITE020 is the Nox solution to those who need a high performance equipment but without sacrificing nor space or an efficient execution.

**OUTER
CHARACTERISTICS**
Dimensions

**INNER
CHARACTERISTICS**

SPECIFICATIONS

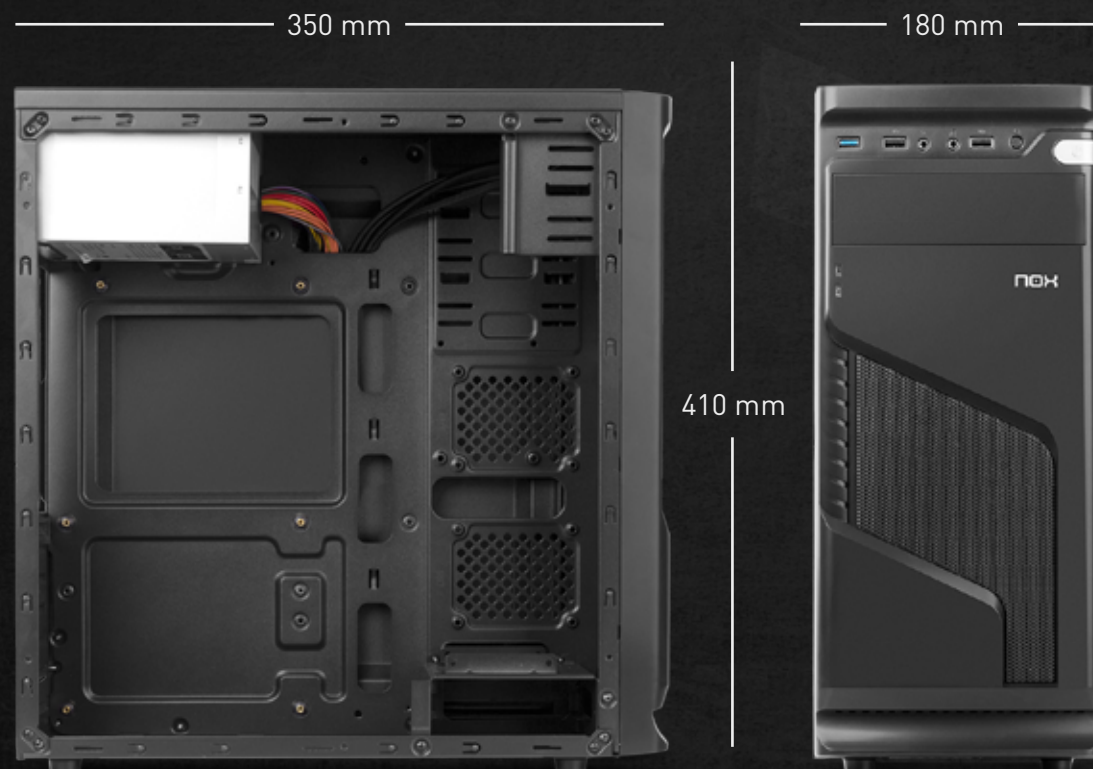

LITE020

500W MID TOWER CHASSIS

OUTER CHARACTERISTICS

Connections

INNER CHARACTERISTICS

SPECIFICATIONS

COMPACT IN THE OUTSIDE, BROAD IN THE INSIDE

LITE020 is the Nox solution to those who need a high performance equipment but without sacrificing nor space or an efficient execution.

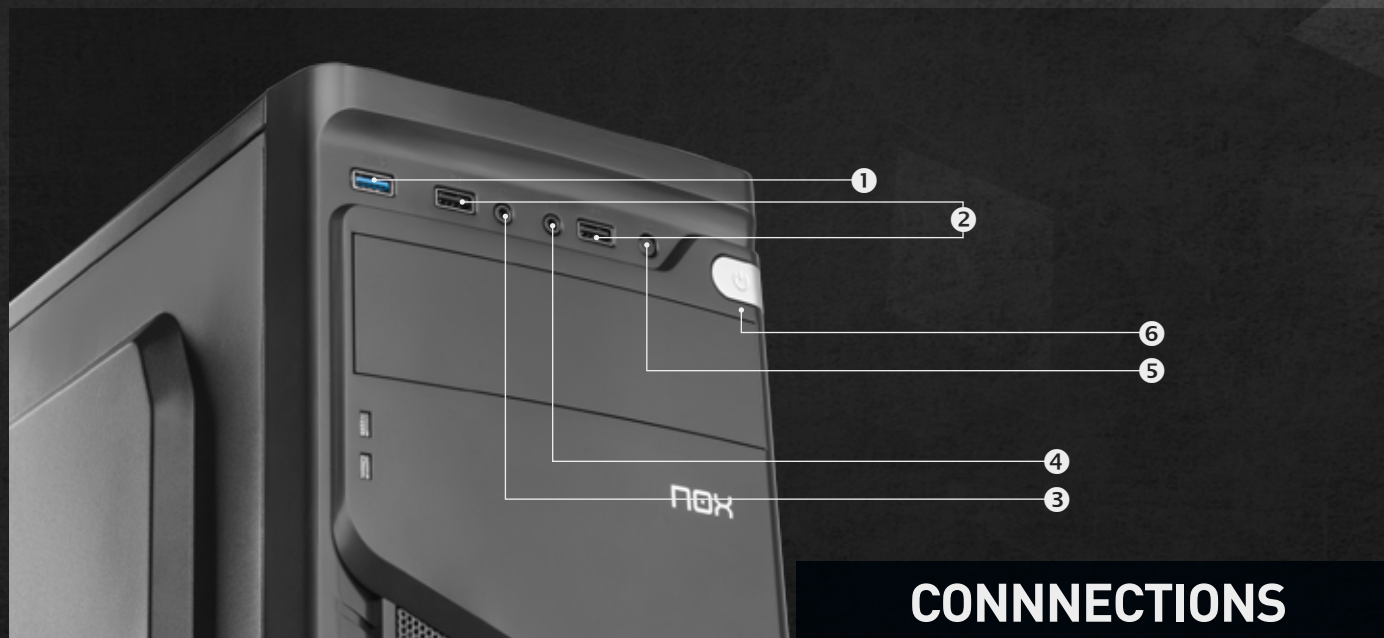

CONNECTIONS

01. USB 3.0

02. USB 2.0

03. Audio Input (3.5mm Jack)

04. Microphone Input (3.5mm Jack)

05. Reboot Button

06. On / Off Button

LITE020

500W MID TOWER CHASSIS

OUTER CHARACTERISTICS

INNER CHARACTERISTICS

Cooling System

SPECIFICATIONS

COMPACT IN THE OUTSIDE, BROAD IN THE INSIDE

LITE020 is the Nox solution to those who need a high performance equipment but without sacrificing nor space or an efficient execution.

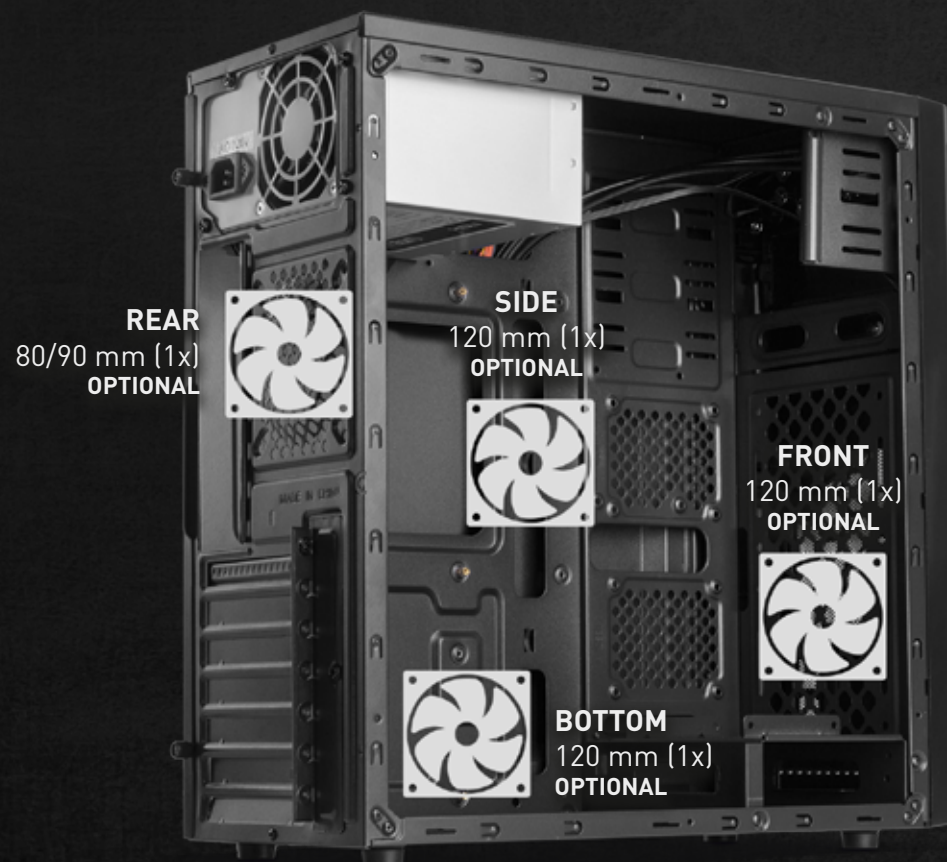

LITE020

500W MID TOWER CHASSIS

OUTER CHARACTERISTICS

INNER CHARACTERISTICS

Airflow

SPECIFICATIONS

**COMPACT IN THE OUTSIDE,
BROAD IN THE INSIDE**

LITE020 is the Nox solution to those who need a high performance equipment but without sacrificing nor space or an efficient execution.

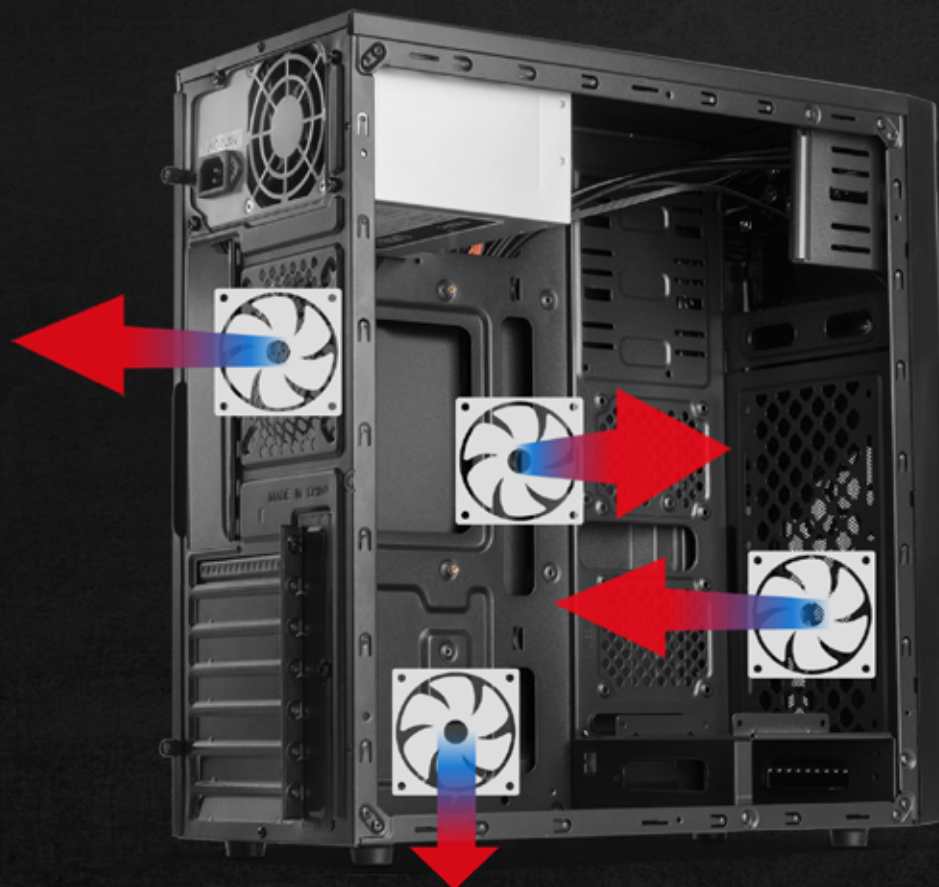

LITE020

500W MID TOWER CHASSIS

OUTER CHARACTERISTICS

INNER CHARACTERISTICS

Internal Space

SPECIFICATIONS

COMPACT IN THE OUTSIDE, BROAD IN THE INSIDE

LITE020 is the Nox solution to those who need a high performance equipment but without sacrificing nor space or an efficient execution.



LITE020

500W MID TOWER CHASSIS

OUTER CHARACTERISTICS

INNER CHARACTERISTICS

Storage SPECIFICATIONS

**COMPACT IN THE OUTSIDE,
BROAD IN THE INSIDE**

LITE020 is the Nox solution to those who need a high performance equipment but without sacrificing nor space or an efficient execution.

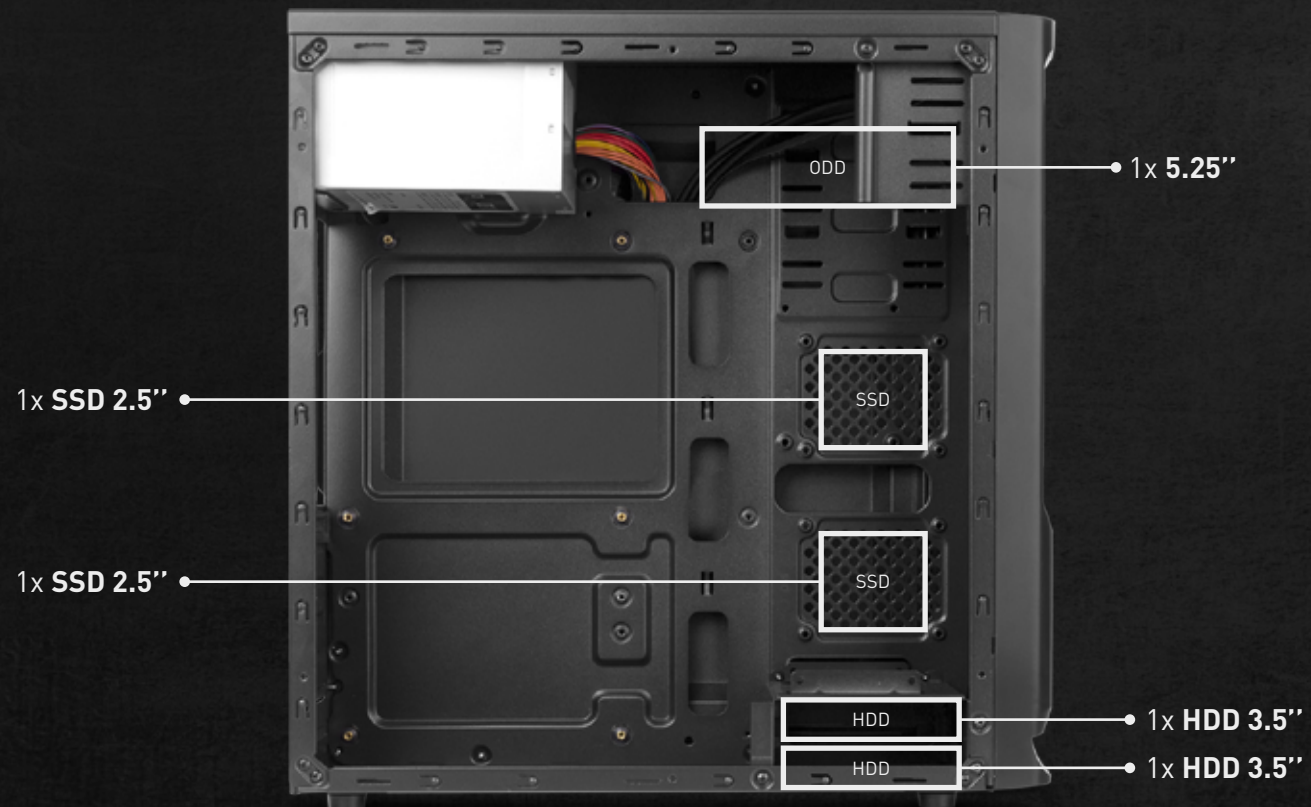

LITE020

500W MID TOWER CHASSIS

**COMPACT IN THE OUTSIDE,
BROAD IN THE INSIDE**

LITE020 is the Nox solution to those who need a high performance equipment but without sacrificing nor space or an efficient execution.

OUTER CHARACTERISTICS

INNER CHARACTERISTICS

SPECIFICATIONS Specifications Table

EXTRAS

- Shiny finish front panel
- High speed USB 3.0
- Up to 3 fans capability
- Power supply included

CHASSIS TYPE SIZE Mid tower

MOTHERBOARD FORM FACTOR ATX • Micro ATX • ITX

EXTERNAL DRIVE BAYS 1x 5.25"

INTERNAL DRIVE BAYS 2x 3.5" / 2x 2.5"

COOLING SYSTEM

- Front: 1x 120 mm (optional)
- Side: 1x 120 mm (optional)
- Rear: 1x 80 / 90 mm (optional)
- Bottom: 1x 120 mm (optional)

EXPANSION SLOTS 7

MATERIAL

- ABS plastic
- SPCC 0.5 mm steel chassis

COLOR Black

CONNECTIONS 1x USB 3.0 • 2x USB 2.0 • HD Audio

MAX. GRAPHIC CARD 365 mm

MAX. CPU COOLER 162 mm

CABLE MANAGEMENT 19 mm

DIMENSIONS 368(D) x 175(W) x 408(H)

WEIGHT (WITHOUT PSU) 3,60 Kg

WEIGHT (WITH PSU) 4,40 Kg

POWER SUPPLY

- 500W
- ATX
- CONNECTORS:
 - 3x SATA
 - 1x Molex 4pin
 - 1x ATX 20/24 pin
 - 1x CPU 4 pin
 - 1x FDD

PN: NXLITE020 • **EAN:** 8436532167850