

nox

# HUMMER VAULT

HIGH PERFORMANCE CHASSIS

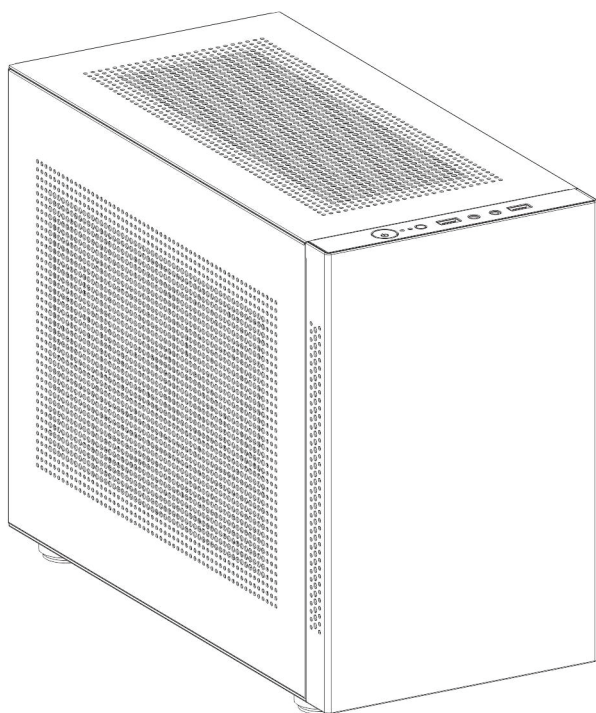

INSTALLATION GUIDE

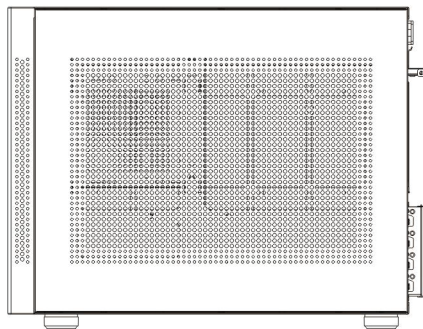
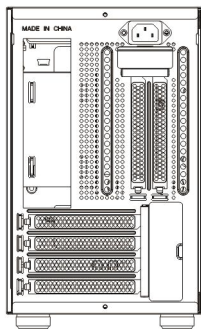
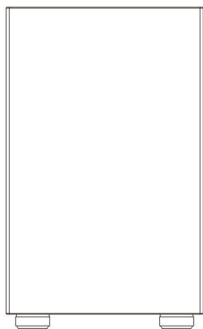

## SPECIFICATIONS

### Main features:

- Micro tower case
- Magnetic dust filter
- Up to 7 fans capability (depends of PSU system used)
- Vertical or horizontal GPU assemble
- High speed USB 3.0 (x2)

### Chassis size type:

Micro tower

### MB form factor:

Micro ATX; ITX

### External drive bays:

-

### Internal drive bays:

3x 3.5" | 3x 2.5"

### Cooling system:

- Top: 2x 120 mm (1x for ATX PSU) (not included)
- Rear: 1x 80 mm (not included)
- Side: 2x 120 mm (not included)
- Bottom: 2x 120 mm (not included)

### Expansion slots:

4x Horizontal | 2x Vertical

### Material:

SPCC 0.8 mm steel chassis | Metal side and front panel

### Dimensions:

185 x 303 x 391 mm (W x H x D)

### Color:

Black

### PSU:

ATX/SFX standard compatible (not included)

### Clearance:

- CPU cooler:
  - 88 mm (vertical Graphic card installed)
  - 155 mm
- VGA card:
  - 245 mm (vertical GPU and ATX PSU)
  - 335 mm (horizontal GPU and ATX)

### Water cooling option:

- Side: 240 / 120 mm (with SFX PSU)

### Ports:

- Bottom: 240 / 120 mm

### Weight:

2x USB 3.0 | HD Audio | Mic  
5.2 Kg

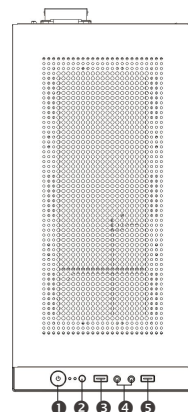
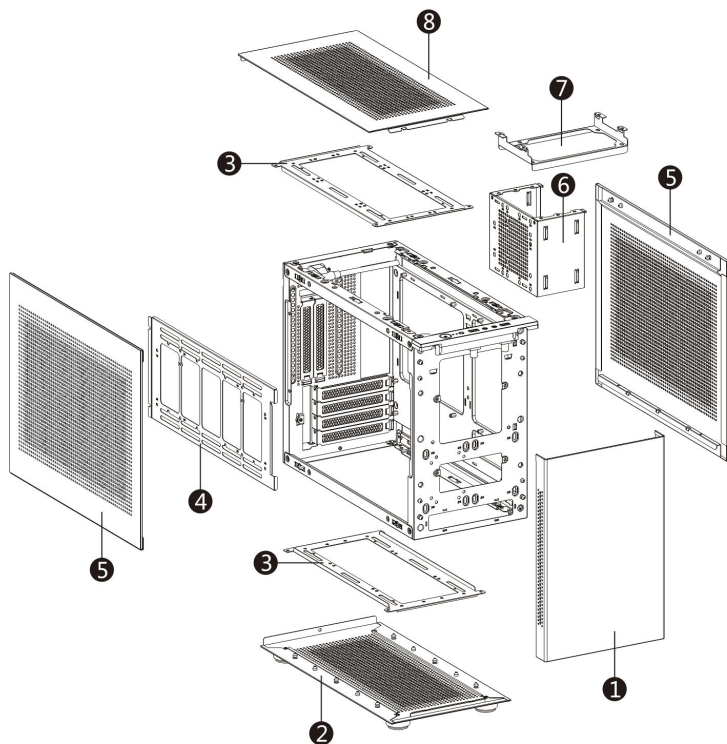

- ① Power
- ② Reset
- ③ USB 3.0
- ④ Audio & Mic
- ⑤ USB 3.0

- ① Front Panel
- ② Bottom Plate
- ③ HDD / Fan Bracket
- ④ Left HDD / Fan Bracket
- ⑤ Side Cover
- ⑥ Micro-PSU Bracket
- ⑦ ATX PSU Bracket
- ⑧ Top Cover

## A



**PSU SCREW (x4)**  
Fixes PSU



**HDD SCREW (x8)**  
Fixes 3.5" HDD units



**MB SCREW (x16)**  
Fixes MB / 2.5" SSD units



**SSD STEP SCREW (x4)**  
Fixes 2.5" SDD units



**HDD STEP SCREW (x4)**  
Fixes 3.5" HDD units



**GASKET (x4)**  
Used on step screws  
fixing 3.5" HDDs



**CABLE TIE A (x8)**  
Used in cable management



**CABLE TIE B (x8)**  
Used in cable management



**COPPER CYLINDER (x1)**  
Used in MB



**COPPER PILLAR (x1)**  
Fixes / Removes copper cylinder

**B**

## DISASSEMBLY

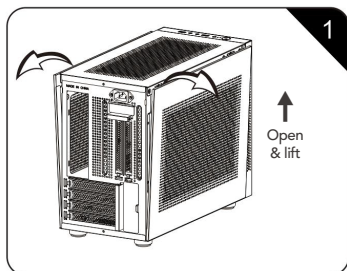

Remove side panels from the back

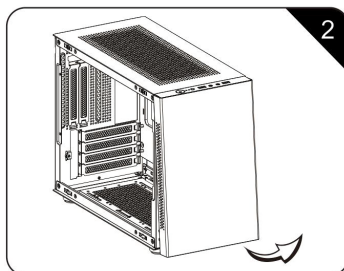

Remove front panel

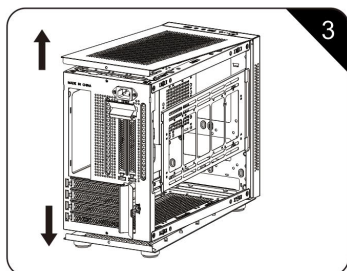

Remove screws on rear plate, then open top and bottom plate

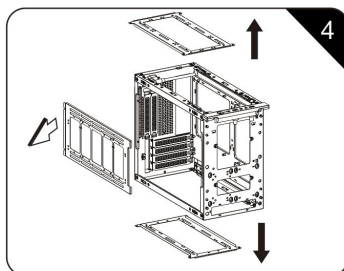

Unscrew to remove HDD / Fan bracket and the side bracket

**C****I**

## MATX MOTHERBOARD INSTALLATION

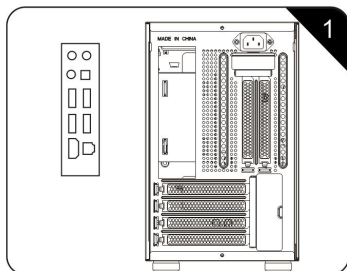

Prepare the IO slot

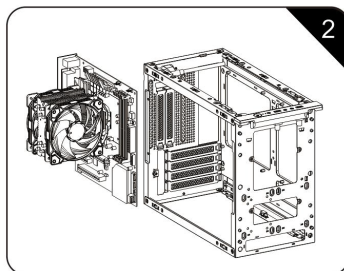

Put the MATX motherboard in the right place

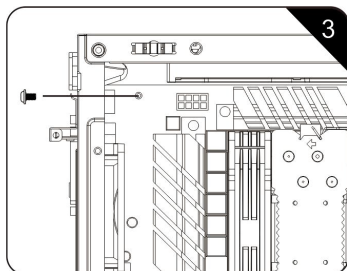

Fix the MATX motherboard using the correct screws

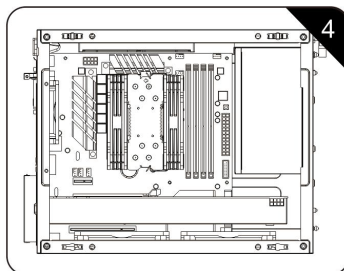

Job done!



C

II

## MATX MOTHERBOARD: ATX PSU INSTALLATION

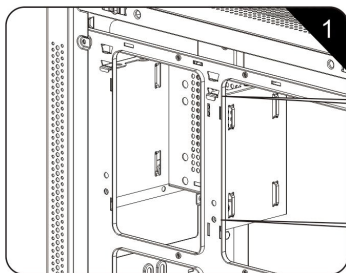

Unscrew the hard drive enclosure from the back of the motherboard tray

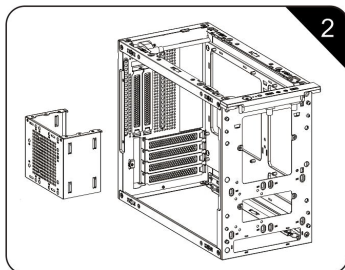

Remove the micro PSU enclosure, place the ATX PSU in the correct position

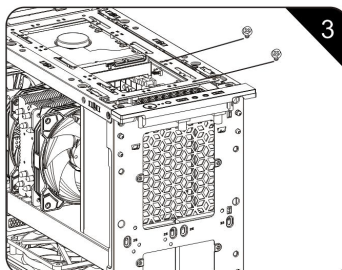

Fix with hexagonal screws from above

C

III

## MATX MOTHERBOARD: SFX PSU INSTALLATION

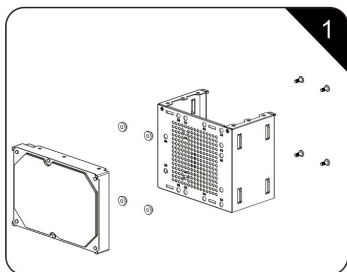

Put in the gaskets before fixing the HDD / SSD with the step screws.  
Apply the correct screws according to:  
**SSD** 2.5" SSD screws | **HDD** 3.5" HDD screws

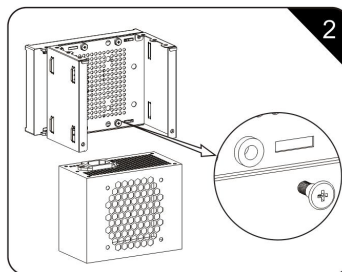

Put in the PSU and fix it using the hexagonal screws

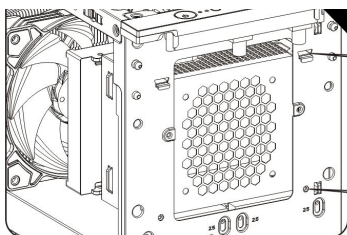

Place the power supply bracket in its location on the front plate and secure it with screws

## ITX MOTHERBOARD INSTALLATION

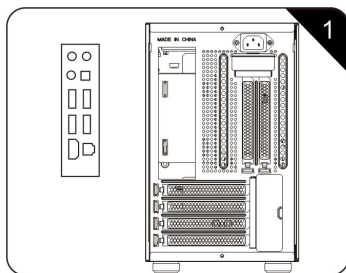

Prepare the IO slot

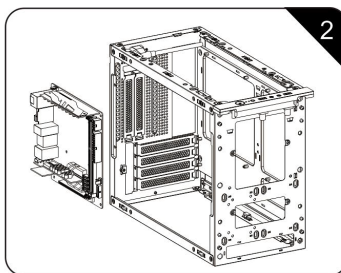

Put the ITX motherboard in the right place

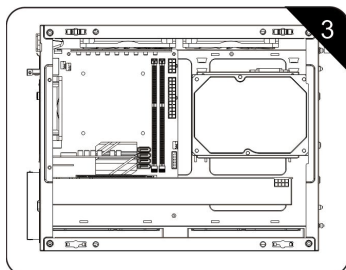

Put the motherboard in the right place

## ITX MOTHERBOARD: ATX PSU INSTALLATION

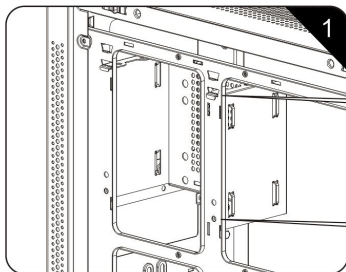

Unscrew the Micro HDD enclosure from the back of the motherboard tray

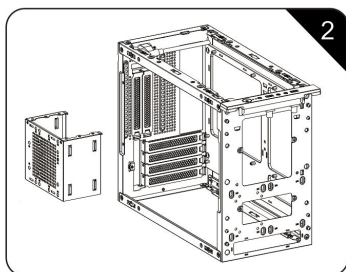
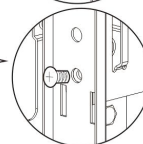

Remove the micro PSU enclosure, place the ATX PSU in the correct position

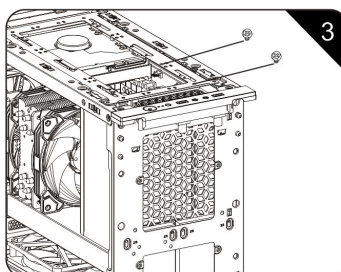

Fix with hexagonal screws from above

## ITX MOTHERBOARD: MICRO PSU INSTALLATION (METHOD 1)

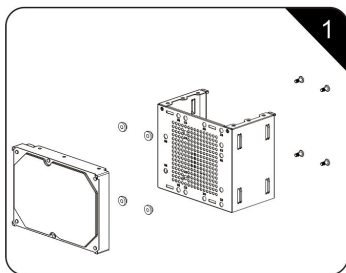

Put in the gaskets before fixing the HDD / SSD with the step screws.  
Apply the correct screws according to:  
**SSD** 2.5" SSD screws | **HDD** 3.5" HDD screws

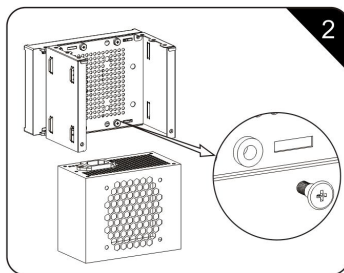

Put in the PSU and fix it using the hexagonal screws

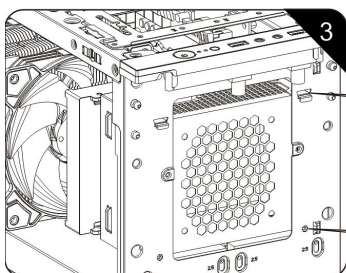

Place the power supply bracket in its location on the front plate and secure it with screws

## ITX MOTHERBOARD: MICRO PSU INSTALLATION (METHOD 2)

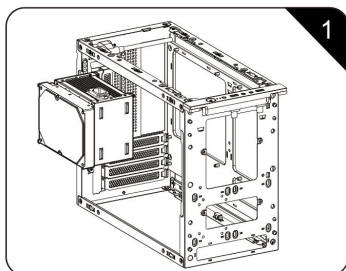

Place the HDD and PSU enclosure at the rear of the chassis

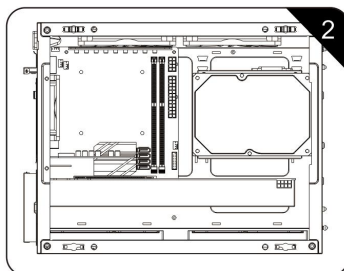

Fix with screws from the rear side of the motherboard tray

E

## MAXIMUM CPU COOLER HEIGHT

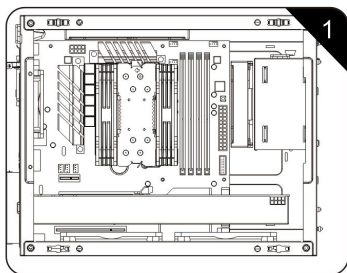

Up to 155mm when the GPU is installed horizontally and without the left side bracket

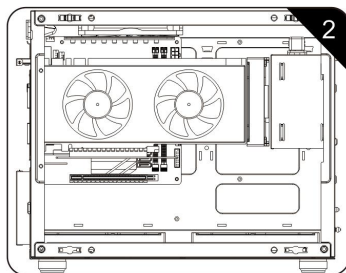

Up to 88mm when the GPU is installed vertically

F

I

## GRAPHIC CARD INSTALLATION

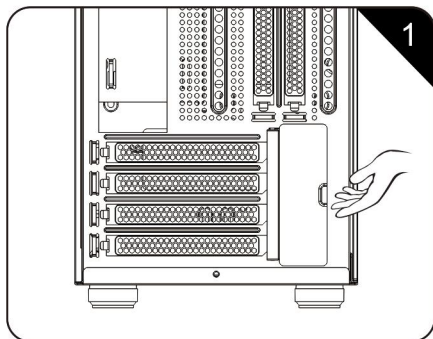

Lift the magnetic PCI bay

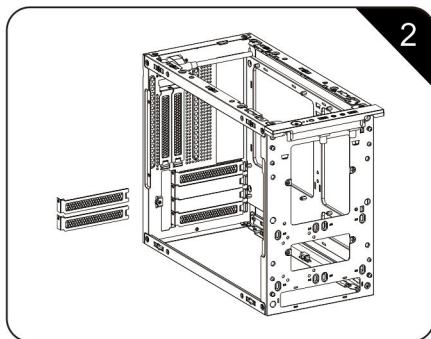

Unscrew and remove the PCI bay

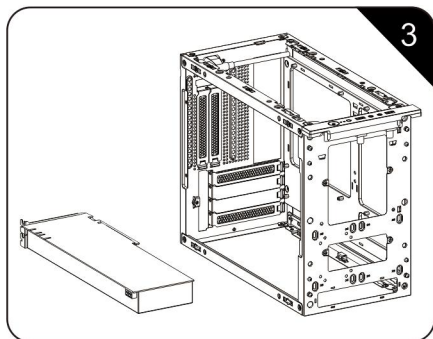

Insert the GPU and fix it with a screw

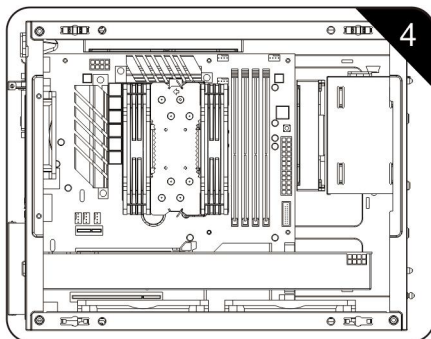

Job's done!

## VERTICAL GPU INSTALLATION

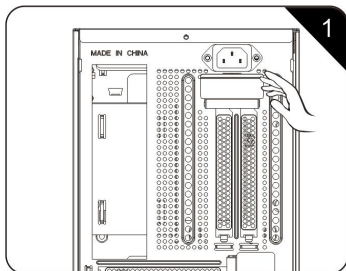

Lift the magnetic cover of the PCI bay and unscrew it

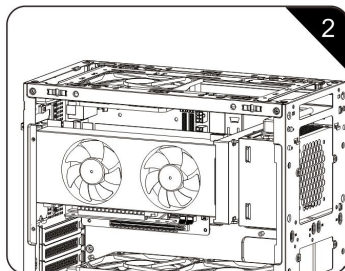

Insert the GPU and fix it with screws, then connect it with the cable

## VERTICAL GPU INSTALLATION: GPU MAX. LENGHT

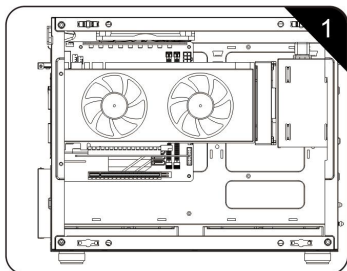

245mm, with Micro PSU  
(when PSU is fixed to the front panel)

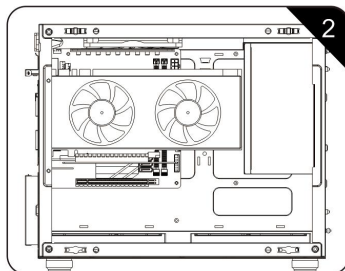

245mm, with ATX PSU

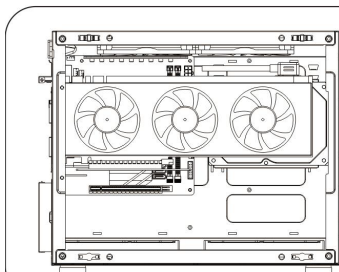

### ITX MOTHERBOARD: MAXIMUM GPU LENGHT

335mm, with Micro PSU (when Micro PSU is fixed to motherboard tray)

G

I

## HDD INSTALLATION ON HDD / FAN BRACKET

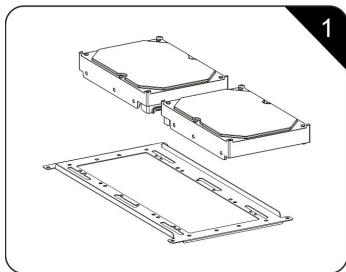

Prepare the SSD / HDD and the bracket

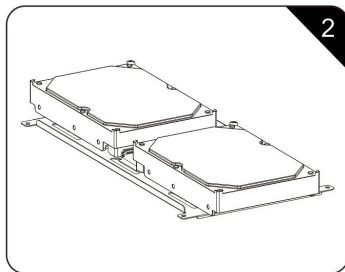

Place the SSD / HDD into the bracket on the side with the raised edge

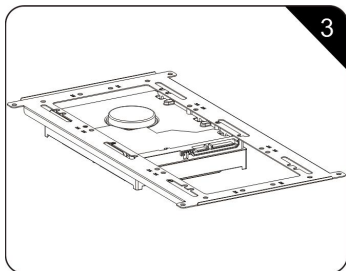

Fix with screws:  
**HDD** HDD screws | **SSD** MB screws

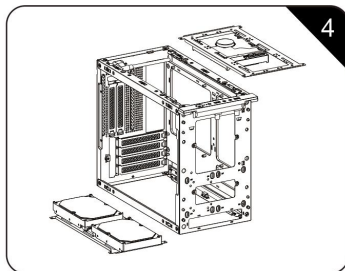

Fix it back to the chassis bottom / top  
(ATX PSU installed: allows only x1 HDD)

G

II

## HDD / SSD INSTALLATION ON FAN LEFT BRACKET

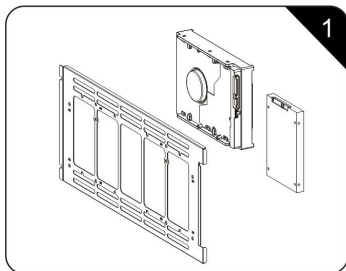

Prepare the SSD / HDD and the bracket

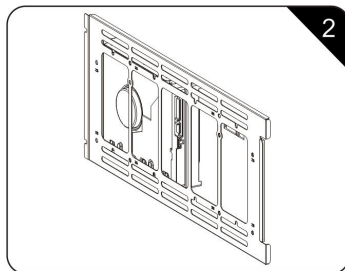

Place the SSD / HDD into the bracket on the side with the raised edge

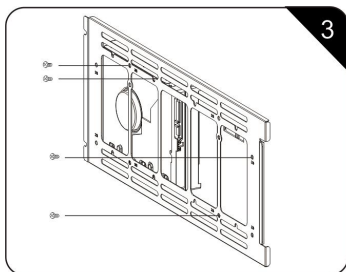

Fix with screws:  
**HDD** HDD screws | **SSD** MB screws

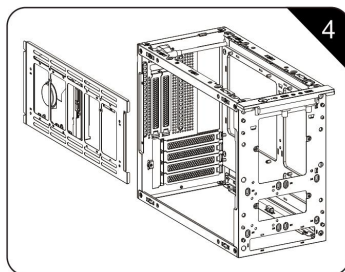

Fix it back to the side of the chassis  
(ATX PSU installed: allows only x1 HDD)



G

III

## FRONT PANEL DUAL SSD INSTALLATION

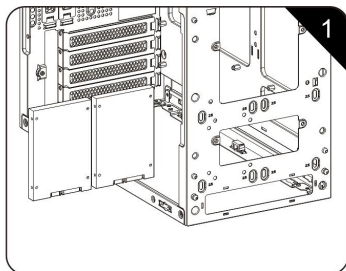

Place the SSD in the location indicated by the screw holes

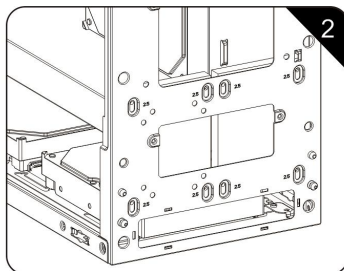

Use motherboard screws to fix it

H

## WATER COOLER INSTALLATION ON HDD / FAN BRACKET

(INSTALLATION SUPPORTED ONLY AT THE BOTTOM)

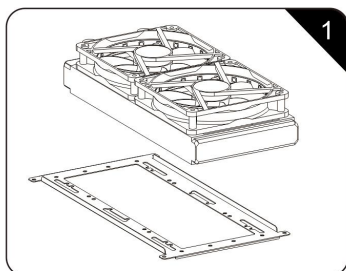

Fix the 120 / 240mm water cooler to the bracket as shown in the picture

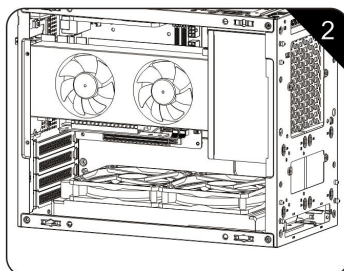

Fix the bracket back to the bottom of the chassis (water cooler installations on the bottom are only supported with vertical GPU and ITX motherboards)

I

I

## REAR PANEL FAN INSTALLATION

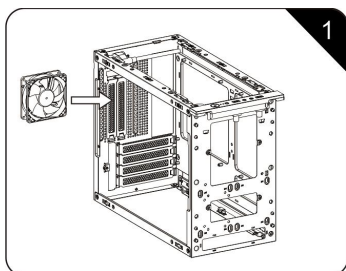

Fix the 8 cm fan with the air outlet correctly oriented

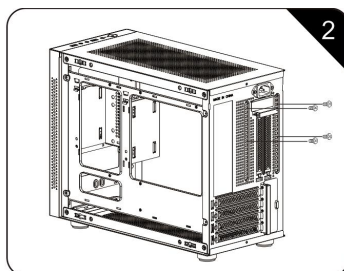

Screw from the back

I

II

## FANS INSTALLATION ON TOP PANEL HDD / FAN BRACKET

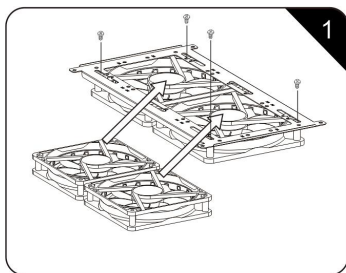

Fix the 12cm fans to the bracket

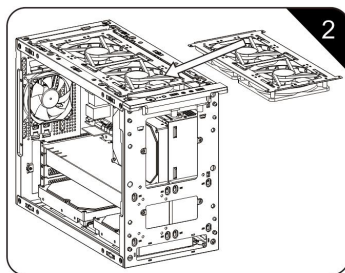

Fix the bracket back into the chassis

I

III

## FANS INSTALLATION ON BOTTOM HDD / FAN BRACKET

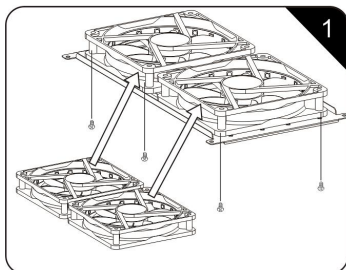

Fix 12cm fans to the bracket with the  
air outlet facing the bottom

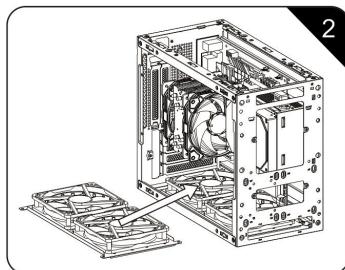

Fix the bracket back into the chassis

I

IV

## FANS INSTALLATION ON LEFT HDD / FAN BRACKET

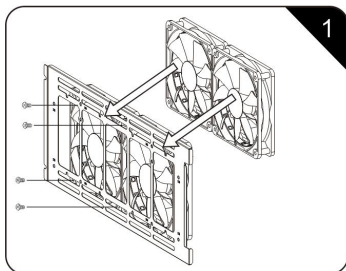

Fix 12cm fans to the bracket with the  
air outlet facing to the left

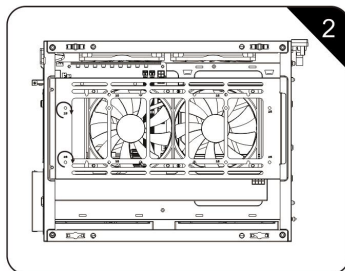

Fix the bracket back into the chassis

**nox**

[www.nox-xtreme.com](http://www.nox-xtreme.com)